

B3G

- Stainless steel IP67 “S” type load cell
- Tension and compression applications
- Suitable for hanging, hopper and other weighing devices
- Also available in imperial capacities and other dimensions
- OIML test certificate no. D09-06.07
- OIML C of C no. R60/2000-CN1-06.02
- NTEP certificate no. 06-099A1



Features

- Capacities: 50kg~10t;50lb~20Klb
- High accuracy
- Stainless steel construction
- Low profile

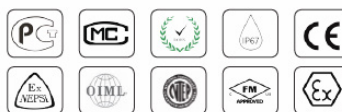

Specifications

Capacity	t	50kg/100kg/250kg/500kg/1t/2.5t/5t/7.5t/10t		
	lb	50/75/100/150/200/250/300/500/750/1k/1.5k/2k/2.5k/3k/5k/10k/15k/20k		
Accuracy		C3	N3	N10
Maximum Number of Verification Intervals	Nmax	3000	3000	10000
Minimum Number of Verification Intervals	Vmin	E _{max} /10000	E _{max} /3000	E _{max} /10000
Output Sensitivity	(mV/V)	3.0±0.008		
Input Resistance	(Ω)	430±60		
Output Resistance	(Ω)	351±2		
Insulation Resistance	(MΩ)	≥5000 (50VDC)		
Zero Balance	(%FS)	1.0		
Temperature, Compensated	(°C)	-10~+40		
Temperature, Operating	(°C)	-35~+70		
Excitation, Recommended	(V)	5~12 (DC)		
Excitation, Max	(V)	18 (DC)		
Safe Overload	(%FS)	150		
Ultimate Overload	(%FS)	300		

Dimensions in mm (in)

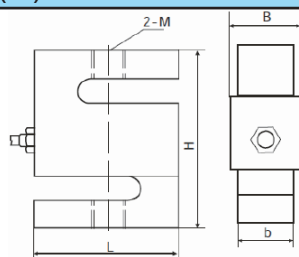

Outline Dimensions mm (inch)

Dimension (mm)	L	H	W1	W	M	H1
Capacity						
50kg, 100kg	50.8 (2.0)	60.96 (2.4)	11.68 (0.46)	15.06 (0.59)	M8	8.89 (0.35)
50lb~300lb					1/4-28UNF	
250kg, 500kg	50.8 (2.0)	60.96 (2.4)	18.03 (0.71)	21.4 (0.84)	M12	
500lb~1.5klb					1/2-20UNF	
1t	50.8 (2.0)	60.96 (2.4)	24.38 (0.96)	27.76 (1.09)	M12	
2, 2.5Klb					1/2-20UNF	
2.5t	76.2 (3.0)	99.06 (3.9)	24.38 (0.96)	27.76 (1.09)	M20x1.5	13.97 (0.55)
3Klb					1/2-20UNF	
5t	74.68 (2.94)	99.06 (3.9)	30.74 (1.21)	34.12 (1.34)	M20x1.5	18.37 (0.72)
10Klb					3/4-16UNF	15.75 (0.62)
7.5t	87.38 (3.44)	139.7 (5.5)	37.08 (1.46)	40.46 (1.59)	M24x2	27.5 (1.08)
15Klb					1-14UNS	
10t	112.78 (4.44)	177.8 (7.0)	42.93 (1.69)	46.31 (1.82)	M30x2	39.9 (1.57)
20Klb					1 1/4-12UNS	
5klb	76.2 (3.0)	99.06 (3.9)	24.38 (0.96)	27.76 (1.09)	3/4-16UNF	13.97 (0.55)

Wiring

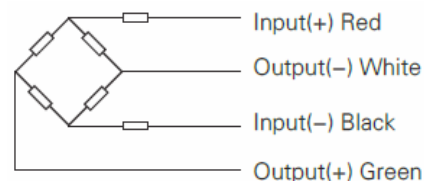

- Shielded, 4 conductor cable
- Cable diameter: 0.2in
- Standard cable length: 6m
- Shield not connected to element